

Be Red Cross Ready

Get a Kit. Make a Plan. Be Informed.

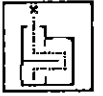

Emergency Plan

Escape Plan

(activity on reverse)

In a fire or other emergency, you may need to evacuate your home on a moment's notice. You should be ready to get out fast.

Develop an escape plan by drawing a floor plan of your home. Show the location of doors, windows, stairways, and large furniture. Indicate the location of emergency supplies (Disaster Supplies Kit), fire extinguishers, smoke detectors, collapsible ladders, first aid kits, and utility shut-off points. Next, use a colored pen to draw a broken line charting at least two escape routes from each room. Finally, mark a place outside of the building where members of your household should meet.

Be sure to include important points outside such as garages, patios, stairways, elevators, driveways and porches. If your home has more than two floors, use an additional sheet of paper.

Make sure to practice your escape plan each time you set your clocks for daylight savings time.

Family Emergency Contact List

keep a copy of this list in a handy place.

keep a copy with your Emergency Supply Kit.

review this list every time you set your clocks for daylight savings time.

Out-of-Town Contact

Name _____

Telephone (DAY) _____ (EVENING) _____

Family Work Numbers

Mom _____ Dad _____

Other _____

Neighbor/Nearest Relative

Name _____

Telephone (DAY) _____ (EVENING) _____

Local Emergency Numbers (9-1-1) or:

Police Dept. _____

Fire Dept. _____

Hospital _____

Doctor's Number

Name _____ Telephone _____

Name _____ Telephone _____

Name _____ Telephone _____

Meeting Places

plan to meet here if you are separated from your family/friends.

Right Outside Your Home

Away from the neighborhood, in case you cannot return home.

Address _____ Telephone _____

Directions _____